

RINO

The elegant RINO sets a new standard for the appearance of ceiling diffusers. It works cleanly, silently, without draught. Its functional design is pleasing to the eye. Even ceiling light fixtures feel at home next to RINO.

RINO is a ceiling-mounted diffuser with an exceptional design and extremely good air and sound properties. The high mixing ratio and wide throw pattern at low flow velocity prevent draughts.

RINO

The structure of **RINO** efficiently keeps the ceiling from becoming soiled because the throw pattern is directed optimally parallel to the ceiling surface. RINO features reliable measurement combined with quick and precise adjustment. RINO is an exclusive ceiling diffuser that does not even look like a supply air device.



QUICK GUIDE

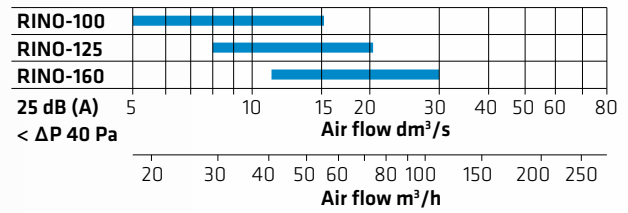

DIMENSIONS

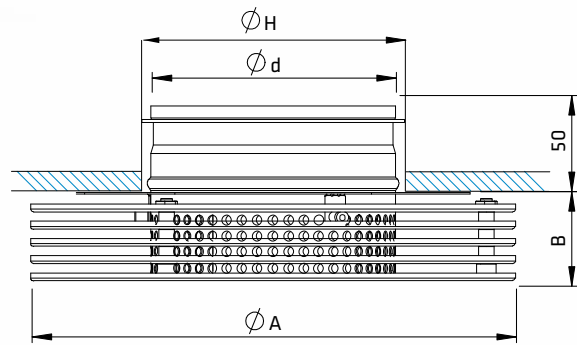
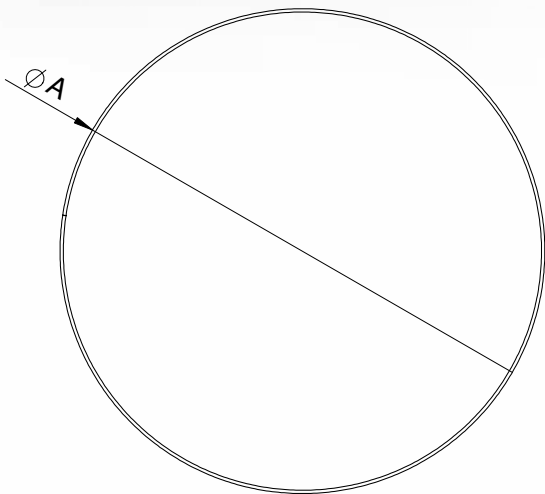

Supply air diffusers

Model	Ød	ØH	ØA	B	Weight, kg
RINO-100	100	115	246	45	1,2
RINO-125	125	140	246	45	1,2
RINO-160	160	175	294	54	1,7

RINO-100

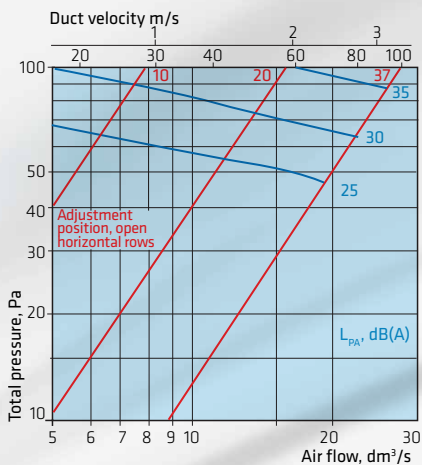

Sound power level L_{pA}

Size	f, Hz	63	125	250	500	1k	2k	4k	8k
RINO-100	K, dB	-6	-6	-3	-1	0	-3	-7	-13

Sound attenuation

Size	f, Hz	63	125	250	500	1k	2k	4k	8k
RINO-100	ΔL , dB	22	15	10	6	2	2	4	6

$L_{w_{okt}} = L_{pA} + K$

RINO-125

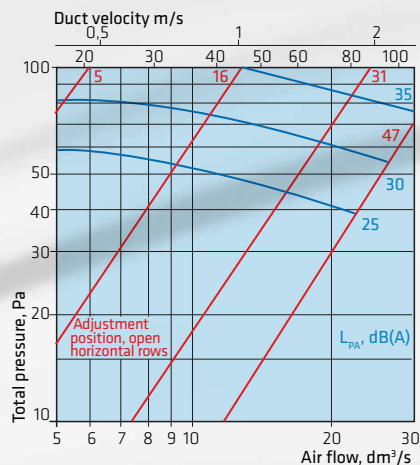

Sound power level L_{pA}

Size	f, Hz	63	125	250	500	1k	2k	4k	8k
RINO-125	K, dB	-14	-7	-3	-1	-1	-3	-5	-11

Sound attenuation

Size	f, Hz	63	125	250	500	1k	2k	4k	8k
RINO-125	ΔL , dB	20	14	9	4	2	2	4	6

$L_{w_{okt}} = L_{pA} + K$

RINO-160

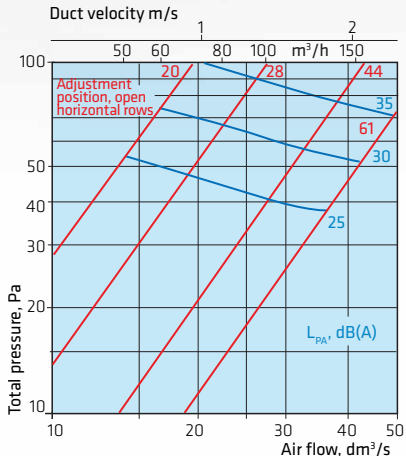

Sound power level L_{pA}

Size	f, Hz	63	125	250	500	1k	2k	4k	8k
RINO-160	K, dB	-11	-3	1	1	0	-5	-7	-14

Sound attenuation

Size	f, Hz	63	125	250	500	1k	2k	4k	8k
RINO-160	ΔL , dB	18	12	7	4	2	2	3	7

$L_{w_{okt}} = L_{pA} + K$

Throw length

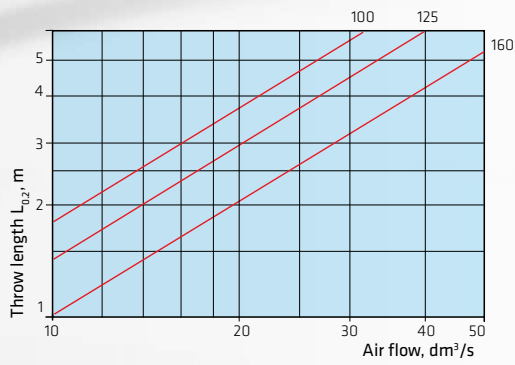

Airborne sound insulation D, n, e, w, dB

Supply air

Size	RINO	RINO+VAL
100	42	61
125	41	65
160	41	64

Throw pattern

