



IR24-P is a presence detector designed for automatic ventilation control of HVAC systems.

- * Power supply 24 V AC or DC
- * Intended for wall or ceiling mounting
- * Unobtrusive design
- * Potentialfree, changeover relay
- * Both relay on-delay and/or relay off-delay, can be individually set

Function

The IR24-P is a presence detector designed for automatic ventilation control of HVAC systems. It saves money and gives higher comfort in premises which require forced ventilation for shorter periods of time, such as conference rooms, assembly-halls etc. The unit provides a changeover relay signal output for start/stop of fan or similar equipment. It can be wall or corner mounted with 110°, 15m detection range.

Range adjustments

In order to suit different rooms or areas, the detection range of IR24-P can be adjusted by changing the direction of the sensor. To change the sensor direction, release the screw on the mounting bracket and then carefully move the sensor to the direction desired.

On / Off Delay

The ON and OFF delays are designed to provide smarter energy management of HVAC systems. ON delay is the time given to the sensor to certify the occupancy, before it activates the output relay. OFF delay is the time that the relay is activated after the last detection. Both ON and OFF delays can be easily set by placing the jumper head on the corresponding pins as following.

	A	B	C	D	E	F
ON	0 sec.	10 sec	30 sec	1 min.	5 min.	10 min
OFF	10 sec.	1 min.	5 min.	10 min	20 min	30 min

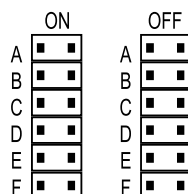

Detection pattern

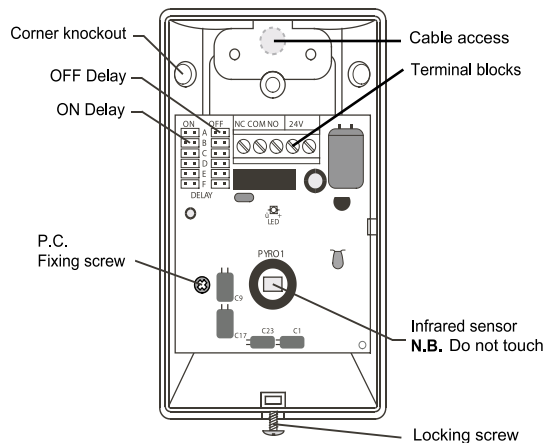
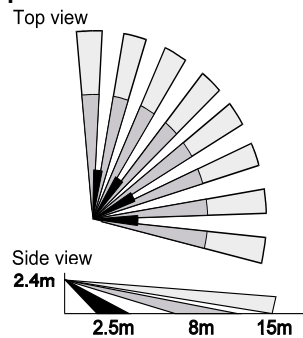

Technical data

Infrared sensor	Dual element	Mounting bracket	MB-99
Power supply	24 ± 2 V AC/DC	Detectable speed	0.1...3.0 m/sec.
Detection range	15 x 15 m at 25°C	RFI immunity	Av. 20 V/m (10...1,000 MHz)
Output relay	24 V AC/DC, 0.2 A max.	Ambient temperature	-20°C...50°C
Consumption	5 mA @24 V AC	Ambient humidity	95% RH max.
Mounting height	1.8...3.6 m	Dimension	112 x 66 x 45 mm

Operation

A. Standby

After the warm up time expires, the sensor enters into standby mode. The detector will check whether both delays are properly set. If not, the green LED will blink to indicate.

B. Relay ON Delay

Relay ON delay is the time given to sensor to verify true occupancy before activating the relay output. Any further detection during ON delay will NOT reset the timer.

C. 1-minute Waiting

When Relay ON delay expires, the sensor enters into a 1-minute waiting time. If no detection occurs within 1 minute, the sensor will return to standby mode. If any detection occurs, then relay output will be activated and Relay OFF delay will be started.

D. Relay OFF Delay

Relay OFF delay is the time of relay activating. Every detection during this period will reset the timer.

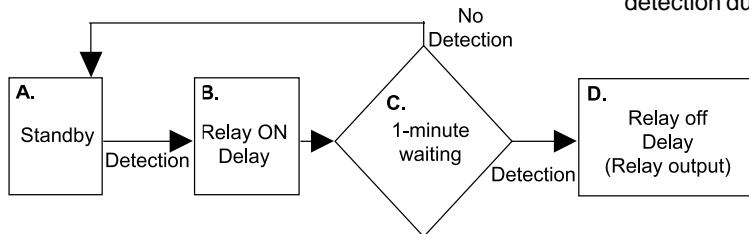

Installation and Wiring

N.B. Do not install where the detector is exposed to direct sunlight or directly above strong sources of heat. Make sure the detection area does not have any obstruction (plants, large pieces of furniture, curtains etc.) which may block the detection.

Installation (see also picture beside)

1. Mount the base of mounting bracket on the selected position. Lead the cable through the access tunnel of mounting bracket or through the knockout openings (see description-picture page 1).
2. Open the front cover by loosening the locking screw at the bottom. Lead the cable into the unit and assemble the mounting bracket with the unit.

Connect the cable to the corresponding terminals according to the instructions below.

Wiring diagram

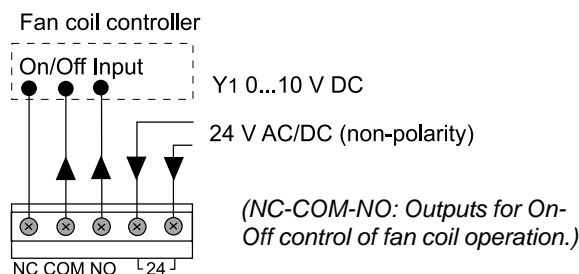

4. Replace the front cover and then proceed with the walk test.

Walk Test

Apply power supply and allows 25 seconds for sensor to warm up. The green LED will blink during warm up period. Walk across the detection zones (invisible) at normal speed. The red LED will blink whenever the sensor detects the motion.

Wall mount

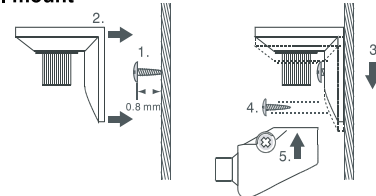

Ceiling mount

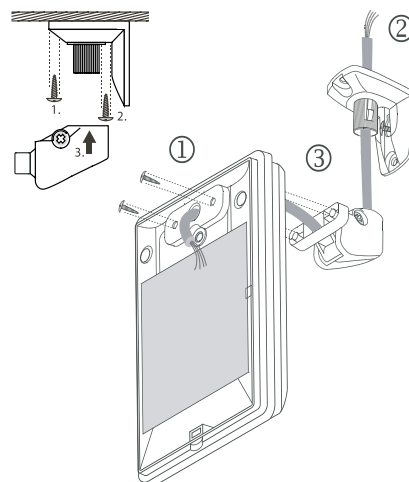

IMPROVING INDOOR CLIMATE CONTROL WORLDWIDE

AB Regin

Head office Sweden

Phone: +46 31 720 02 00 Website: www.regin.se
Fax: +46 31 94 01 46 E-mail: info@regin.se

Regional office Asia Pacific

Phone: +65 6747 82 33 Web site: www.regin.com.sg
Fax: +65 6747 92 33 E-mail: info@regin.com.sg